



Medical

	Type SH5350 24V 100W GY6,35
	Ordering – No. 55350
Product Description	Special Halogen Lamp
Features	Quartz bulb, Exactly positioned Filament
Applications	Medical, Microscope, Analysis

Technical Details

Category	HLL
Rated voltage (A)	24
Wattage (W)	100W +/- 10%
Luminous flux (Lm)	2000 +/- 12%
Average lifetime (hours)	2000
Base	GY6,35-15
Overall Length (mm)	max. 44
Bulb Diameter (mm)	max. 11,0
Light Center Length (mm)	30,0 +/- 0,25
Operating Position	s90
Packaging Configuration	100 pcs.
Environmental Remark	Product don't contain lead or mercury and is conform with Directive 2011/95/EC "Restriction of the use of certain hazardous substances in electrical and electronic equipment".

Drawing (in mm)

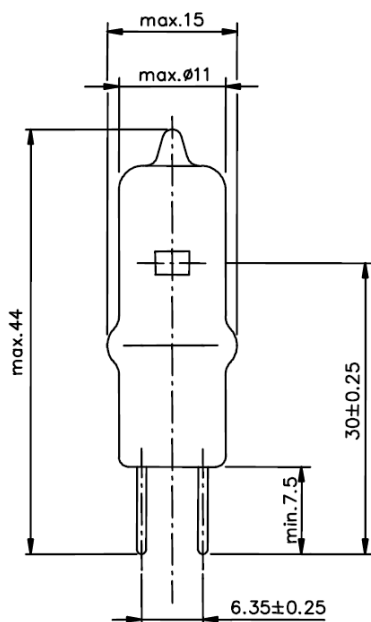

valid from	07..01..2020
replace for	
file	55350.100.pdf